

50.240 M

Hexagonal locknut M40X1,5

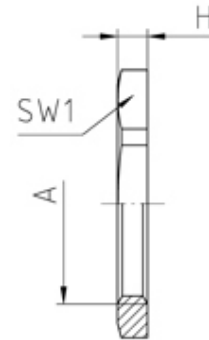

SPECIFICATION

Product Type	Standard
Body Material	Nickel Plated Brass
Max Temperature Rating °C	200
Thread Size	M40
Internal Connecting Thread Type	Metric, as per EN 60423
With Cutting Edges	For secure tightening of EMC-cable glands, to cut through paint layers or powder coatings ensuring o
Width Across Flat 1 (mm)	46
Height (mm)	5
Connecting Thread Size	M40x1.5
Additional Material Detail	Body - Brass CuZn39Pb3 nickel plated