

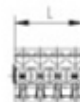

# Plug and Socket PCB Terminal Blocks

Range: PCB Terminal Blocks, Connectors and Fuse Holders

Order Code: FW14304VBFC

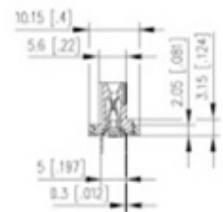
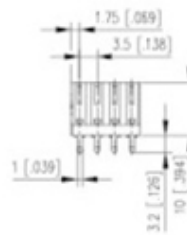

## DESCRIPTION

4 Pole vertical Female Connectors 3.5mm pitch 10A 130V

*Subject to technical modification without notice.*

*Typographical and other errors do not justify claim for damages.*

## SPECIFICATION

<b>Type</b>	Cable mount - Female plug
<b>Connection Method</b>	Screw
<b>Mounting Type</b>	Rising clamp
<b>Orientation</b>	Vertical
<b>Pitch (mm)</b>	3.5
<b>Number of Poles</b>	4
<b>Max Current (A)</b>	10
<b>Max Voltage (V)</b>	130
<b>Height (mm)</b>	3.15
<b>Standard Colour</b>	Black
<b>Width (mm)</b>	10.15
<b>Length (mm)</b>	14
<b>Solder Pin Length (mm)</b>	3.2
<b>PCB Hole Diameter (mm)</b>	1.2
<b>Comments</b>	Pole sizes / no of ways not shown, please contact us for availability
<b>IP Rating</b>	20
<b>Pin Style</b>	Solderable
<b>Tracking Resistance CTI (v)</b>	600