

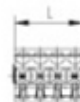

Plug and Socket PCB Terminal Blocks

Range: PCB Terminal Blocks, Connectors and Fuse Holders

Order Code: FW14303VBFC

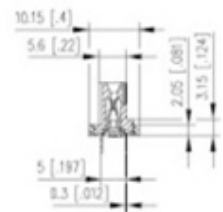
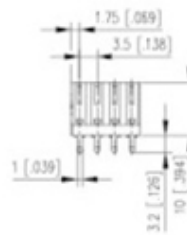

DESCRIPTION

3 Pole vertical Female Connectors 3.5mm pitch 10A 130V

Subject to technical modification without notice.

Typographical and other errors do not justify claim for damages.

SPECIFICATION

Type	Cable mount - Female plug
Connection Method	Screw
Mounting Type	Rising clamp
Orientation	Vertical
Pitch (mm)	3.5
Number of Poles	3
Max Current (A)	10
Max Voltage (V)	130
Height (mm)	3.15
Standard Colour	Black
Width (mm)	10.15
Length (mm)	10.5
Solder Pin Length (mm)	3.2
PCB Hole Diameter (mm)	1.2
Comments	Pole sizes / no of ways not shown, please contact us for availability
IP Rating	20
Pin Style	Solderable
Tracking Resistance CTI (v)	600