

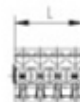

Plug and Socket PCB Terminal Blocks

Range: PCB Terminal Blocks, Connectors and Fuse Holders

Order Code: FW14302VBFC

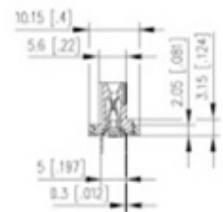
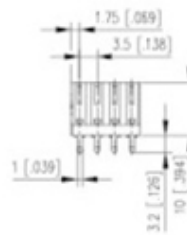

DESCRIPTION

2 Pole vertical Female Connectors 3.5mm pitch 10A 130V

Subject to technical modification without notice.

Typographical and other errors do not justify claim for damages.

SPECIFICATION

Type	Cable mount - Female plug
Connection Method	Screw
Mounting Type	Rising clamp
Orientation	Vertical
Pitch (mm)	3.5
Number of Poles	2
Max Current (A)	10
Max Voltage (V)	130
Height (mm)	3.15
Standard Colour	Black
Width (mm)	10.15
Length (mm)	7
Solder Pin Length (mm)	3.2
PCB Hole Diameter (mm)	1.2
Comments	Pole sizes / no of ways not shown, please contact us for availability
Pin Style	Solderable
Tracking Resistance CTI (v)	600