

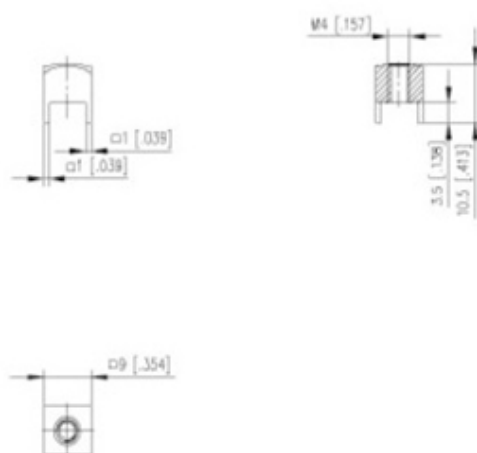

# Standard PCB Terminal Blocks

Range: PCB Terminal Blocks, Connectors and Fuse Holders

Order Code: 700443-0156 M4



## DESCRIPTION

Screw PCB terminal block

*Subject to technical modification without notice.*

*Typographical and other errors do not justify claim for damages.*

## SPECIFICATION

Type	Screw
Mounting Type	Wave - through hole
Height (mm)	10.5
Standard Colour	Metallike
Solder Pin Length (mm)	3.5
PCB Hole Diameter (mm)	1.6
Comments	Pole sizes / no of ways not shown, please contact us for availability
Pin Style	Single pole