

211 PA

Hexagonal locknut PA7035 PG11 Material - Body - Polyamide PA6 GF30

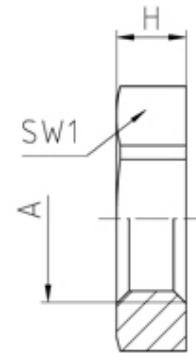

SPECIFICATION

| | |
|--|---------------------------|
| Product Type | Standard |
| Body Material | Polyamide |
| Min Temperature Rating °C | -40 |
| Max Temperature Rating °C | 100 |
| Colour | Light Grey - RAL 7035 |
| Thread Size | PG11 |
| Internal Connecting Thread Type | Pg as per DIN 40430 |
| Width Across Flat 1 (mm) | 24 |
| Height (mm) | 5 |
| Connecting Thread Size | Pg 11 |
| Additional Material Detail | Body - Polyamide PA6 GF30 |