

### 03M20MO

Pressure screw M20X1.5 thread length 7.5 M20x1.5 Body - Brass CuZn39Pb3 nickel plated

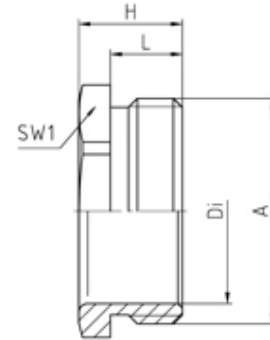

### SPECIFICATION

<b>Product Type</b>	Standard
<b>Body Material</b>	Nickel Plated Brass
<b>Max Temperature °C</b>	200
<b>IP Rating</b>	dependent on the combination with other components
<b>Hole Diameter (mm)</b>	15.5
<b>Thread Size</b>	M20
<b>External Connecting Thread Type</b>	Metric
<b>Thread Length (mm)</b>	7.5
<b>Width Across Flat 1 (mm)</b>	20
<b>Height (mm)</b>	10.5
<b>Connecting Thread Size</b>	M20x1.5
<b>Additional Material Detail</b>	Body - Brass CuZn39Pb3 nickel plated