

## Type 086

Screw type terminal block, solderable, centerline 3.81 mm / 0.150 inches, horizontal wire entry, lift system

### Technical Data

0.12 - 1.5 mm<sup>2</sup> 130 V / 2,5 kV / 12 A

Insulation co-ordination according to EN 60664-1

Clearance and creepage distances	min. 2 mm		
Insulating material class	CTI 600		
Overvoltage category	III	III	II
Pollution degree	3	2	2
Rated voltage	160	400	400
Rated test voltage	2.5	4	2.5

Protection category according to IEC 60529 IP00

Tightening torque UL	1.3 lb-in max.
Min. insul. strip length	5 mm
Solder pin dimension	0.5 x 0.9 mm
Recommended pc board hole dia.	Ø 1.1 mm
Solder pin length	3.5 mm
Pole size	2 - 24
Colour	black

Dimensions in mm 1 mm = 0.0394 in.

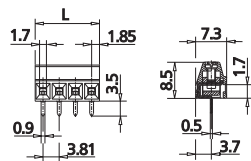

L = (pole size - 1) x centerline + 3.81 mm / 0.150 inches

### Part numbers (P/N)

(informations: page 56)

Complete the part number by adding the pole size.

#### Type 086

centerline 3.81 mm / 0.150 inches

P/N 310861

	02	03	04	05	06	07	08
<input type="checkbox"/>	09	10	11	12	13	14	15
<input type="checkbox"/>	16	17	18	19	20	21	22
<input type="checkbox"/>	23	24					

\* approval pending

- Standard pole sizes
- Available on demand. Minimum order quantity 5000 pieces per item.